

MAX-TRES

Lavabos

Ref.:

N

Monomando lavabo

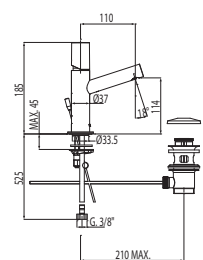

91.07.190.05

Cr

061.103.01



91.07.190.05

Cr

061.103.01.D

Ø37

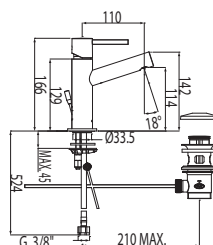

91.07.190.05

Cr

062.103.01



91.07.190.05

Cr

062.103.01.D

Ref.:

MEDIDAS ESPECIALES

N

Monomando lavabo
Caño largo

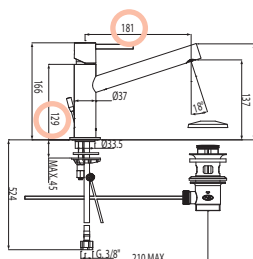
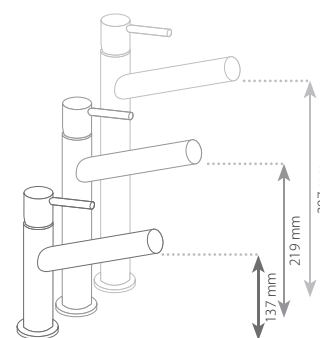
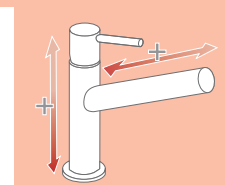

		Cr	062.203.01
--	--	----	------------

		Cr	062.203.01.D
--	--	----	--------------

Ø37

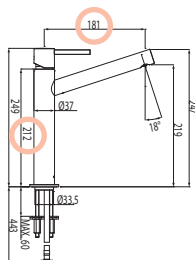

		Cr	062.206.01
--	--	----	------------

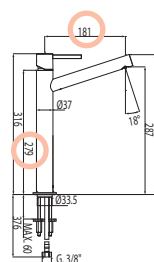

		Cr	062.207.01
--	--	----	------------

Cr = Cromo

Recomendado montar válvula SIMPLE RAPID (NO INCLUIDA)

MAX-TRES

Ref.:

N

Monomando lavabo

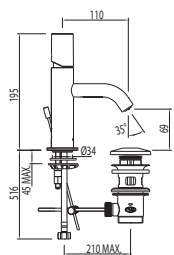

91.07.190.05

Cr

061.903.01



91.07.190.05

Cr

061.903.01.D

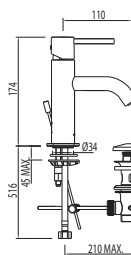

91.07.190.05

Cr

062.903.01



91.07.190.05

Cr

062.903.01.D

N

Monomando lavabo Con alargadera

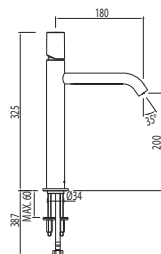

91.07.190.05

Cr

061.307.01

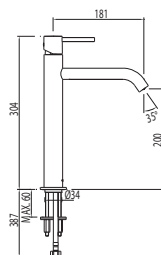

91.07.190.05

Cr

062.307.01

Cr = Cromo

Recomendado montar válvula SIMPLE RAPID (NO INCLUIDA)

Ref.:

N

Monomando lavabo

* NOTA: La grifería con caño cascada incluye 2 llaves de regulación con filtro (Ref: 91.34.525)

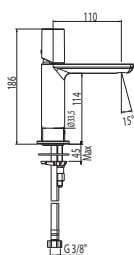

1

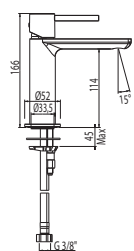

2



91.30.190

Cr

061.103.02



91.30.190

Cr

061.103.02.D



91.30.190

Cr

061.103.03



91.30.190

Cr

061.103.03.D



91.30.190

Cr

062.103.02



91.30.190

Cr

062.103.02.D



91.30.190

Cr

062.103.03



91.30.190

Cr

062.103.03.D

N

Monomando lavabo con caño cascada libre

* NOTA: La grifería con caño cascada se acompaña con 2 llaves de regulación con filtro (Ref: 91.34.525)

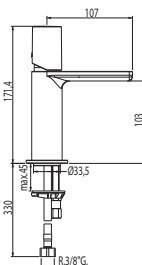

91.30.190

Cr

061.110.01

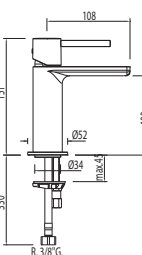

91.30.190

Cr

062.110.01

Cr = Cromo

Recomendado montar válvula SIMPLE RAPID (NO INCLUIDA)

MAX-TRES

Ref.:

N Monomando lavabo
Con alargadera

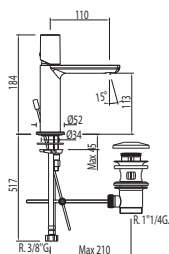
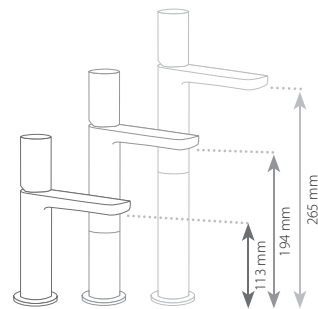

91.30.190 Cr 061.103.02



91.30.190 Cr 061.103.02.D



91.30.190 Cr 061.103.03



91.30.190 Cr 061.103.03.D

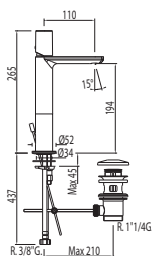

91.30.190 Cr 061.103.04



91.30.190 Cr 061.103.04.D



91.30.190 Cr 061.103.05



91.30.190 Cr 061.103.05.D

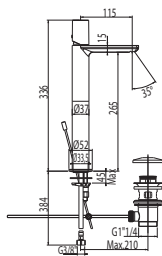

91.30.190 Cr 061.103.06



91.30.190 Cr 061.103.06.D



91.30.190 Cr 061.103.07



91.30.190 Cr 061.103.07.D

* NOTA: La grifería con caño cascada incluye 2 llaves de regulación con filtro (Ref: 91.34.525)

Cr = Cromo

Recomendado montar válvula SIMPLE RAPID (NO INCLUIDA)

Ref.:

N Monomando lavabo
Con alargadera

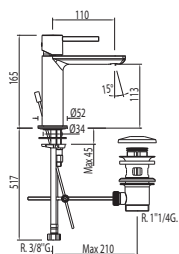
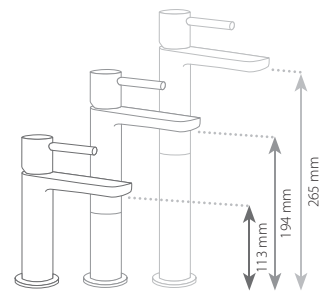

91.30.190 Cr 062.103.02



91.30.190 Cr 062.103.02.D



91.30.190 Cr 062.103.03



91.30.190 Cr 062.103.03.D



91.30.190 Cr 062.103.04



91.30.190 Cr 062.103.04.D



91.30.190 Cr 062.103.05



91.30.190 Cr 062.103.05.D



91.30.190 Cr 062.103.06



91.30.190 Cr 062.103.06.D



91.30.190 Cr 062.103.07



91.30.190 Cr 062.103.07.D

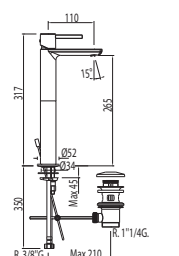
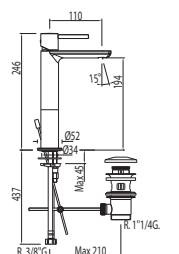

* NOTA: La grifería con caño cascada incluye 2 llaves de regulación con filtro (Ref: 91.34.525)

Cr = Cromo

Recomendado montar válvula SIMPLE RAPID (NO INCLUIDA)

MAX-TRES

Ref.:

N Monomando lavabo

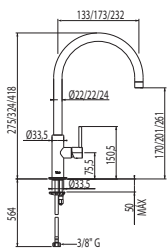
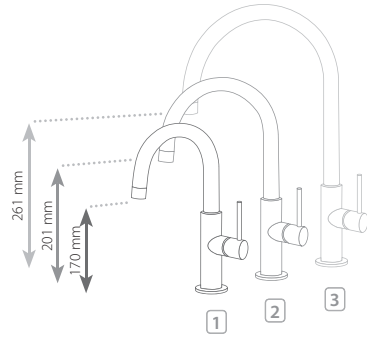

1	91.30.190	Cr	062.904.03
2	91.30.190	Cr	062.904.02
3	91.30.190	Cr	062.904.01

N Monomando lavabo
caño de 35x15 mm.

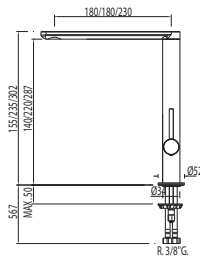
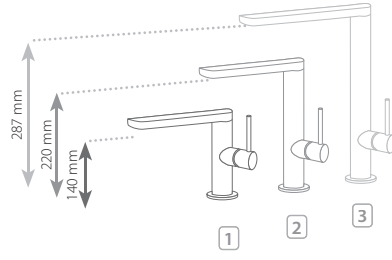

1	91.30.190	Cr	062.905.03
2	91.30.190	Cr	062.905.02
3	91.30.190	Cr	062.905.01

Cr = Cromo

Recomendado montar válvula SIMPLE RAPID (NO INCLUIDA)

Ref.:



Monomando lavabo

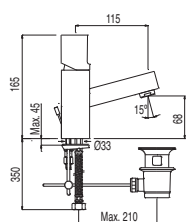

Cr	1.61.103	
Nog	1.61.103.60	



Cr	1.66.103	
Nog	1.66.103.60	

Ø45

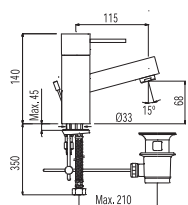

Cr	1.62.103	
----	----------	--



Cr	1.67.103	
----	----------	--



Monomando lavabo
Caño largo

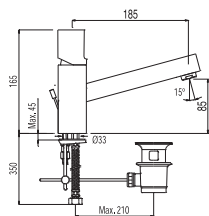

Cr	1.61.203	
Nog	1.61.203.60	



Cr	1.66.203	
Nog	1.66.203.60	

Ø45

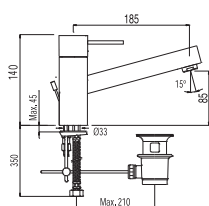

Cr	1.62.203	
----	----------	--



Cr	1.67.203	
----	----------	--

Cr = Cromo Nog = Grifo cromado con volante de Nogal

Recomendado montar válvula SIMPLE RAPID (NO INCLUIDA)

MAX-TRES

Ref.:

N



Grifo lavabo 1 agua

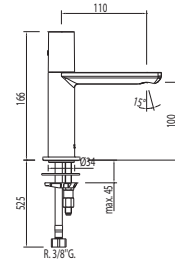

91.34.282

Cr 200.503.01



Monomando lavabo
eficiente

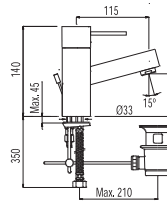

91.34.385.10

Cr 1.62.104.02



91.34.385.10

Cr 1.67.104.02



Lavabo electrónico
TOUCH-TRES
Sistema sensible al tacto.
Sólo tocar (NO pulsar)

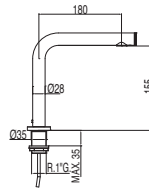

Un agua

Sistema Patentado®



035

Cr 061.447.01

Mezclador

Sistema Patentado®



035

Cr 061.448.01



Lavabo electrónico
TOUCH-TRES
Sistema sensible al tacto.
Sólo tocar (NO pulsar)

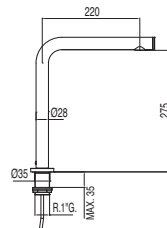

Un agua

Sistema Patentado®



035

180°

Cr 1.61.445

Mezclador

Sistema Patentado®



035

180°

Cr 1.61.446



Ref.:

Grifo lavabo 1 agua

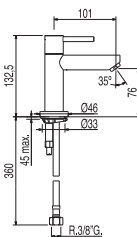

91.34.272.20

Cr

1.62.503

Monomando lavabo Ø 30 mm.

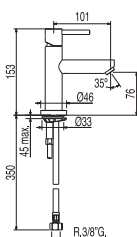

91.62.190

Cr

1.62.603

Monomando mural

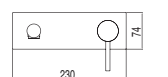
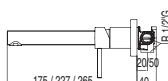

91.34.592

Cr

(16 cm.)

062.200.01



91.34.592

Cr

(21 cm.)

062.200.02



91.34.592

Cr

(25 cm.)

1.62.200

Monomando mural con caño cascada

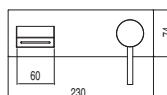
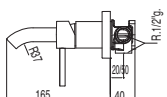

91.34.592

Cr

1.62.260

Caño pared

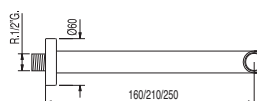

Cr

(16 cm.)

1.61.170.02



Cr

(21 cm.)

061.172.02



Cr

(25 cm.)

1.61.171.02

Caño cascada bañera-ducha

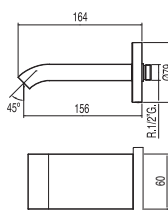

Cr

1.87.181.50

Cr = Cromo



Recomendado montar válvula SIMPLE RAPID (NO INCLUIDA)

MAX-TRES

Bidé

Ref.:

N

Monomando bidé

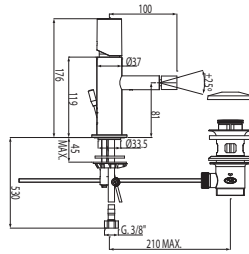

91.07.190.05

Cr

061.120.01



91.07.190.05

Cr

061.120.01.D

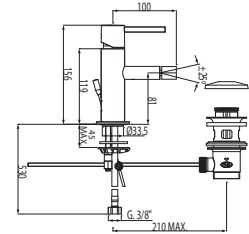

91.07.190.05

Cr

062.120.01



91.07.190.05

Cr

062.120.01.D

N

Monomando bidé

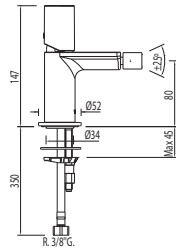

91.30.190

Cr

061.220.01



91.30.190

Cr

061.220.01.D

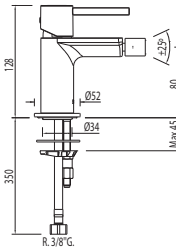

91.30.190

Cr

062.220.01



91.30.190

Cr

062.220.01.D

N

Monomando bidé

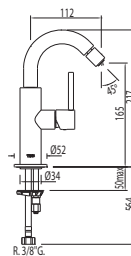

91.30.190

Cr

062.224.02

Cr = Cromo

Ref.:

Monomando bidé

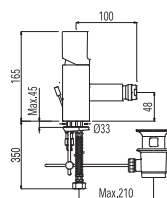

91.34.288

Cr	1.61.120
Nog	1.61.120.60



91.34.288

Cr	1.66.120
Nog	1.66.120.60

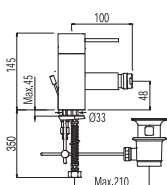

91.34.288

Cr	1.62.120
----	----------



91.34.288

Cr	1.67.120
----	----------



Monomando empotrar para bidé WC

Soporte derecha o izquierda, cambiable.
Ducha de latón con racord limitador 5 l/m.
Antigoteo y flexo SATIN

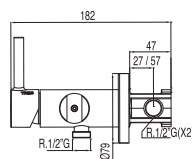

LATÓN



91.34.591

Cr	1.34.123
Cr	1.34.122 *



Monomando lavabo para bidé WC

Duchita con cierre y flexo SATIN

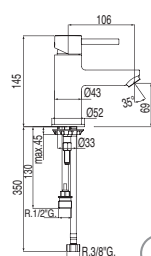

Sistema Patentado®



91.34.592.10

Cr	1.62.113
----	----------



Monomando empotrar para bidé WC

Ducha de latón con racord limitador 5 l/m.
Antigoteo y flexo SATIN

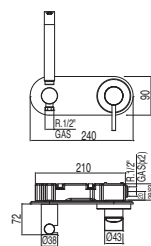

LATÓN



91.34.591

Cr	1.62.123
Cr	1.62.122 *

* Opción para paredes de Pladur

MAX-TRES

Ref.:

N



Monomando bidé con duchita

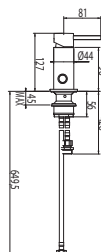

91.34.592

Cr

062.130.01

Monomandos baño

Ref.:

N



Monomando ducha
Ducha anticalcárea (034.116.01) y flexo SATIN (91.34.609.15).

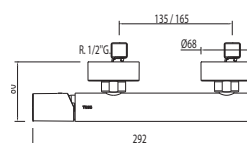

91.30.190



LATÓN

Cr

061.167.01

N



Monomando bañera-ducha
con cascada. Ducha anticalcárea (034.116.01) y flexo SATIN (91.34.609).

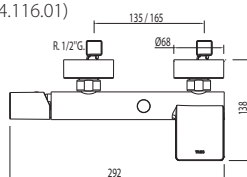

91.30.190



LATÓN

Cr

061.170.01



2 tomas suelo de bañera
Con soporte giratorio

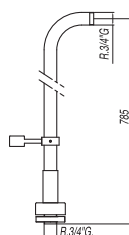

Cr

1.61.194

Cr = Cromo

Empotrados

Ref.:

N

Monomando empotrar ducha

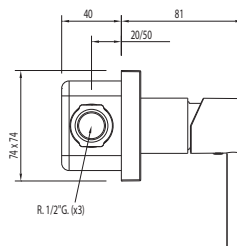

91.30.190

Cr

062.177.02

N

Monomando empotrar baño-ducha

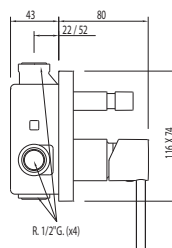

91.30.190

Cr

062.180.02

Monomando empotrar ducha

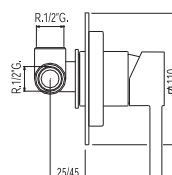

91.34.288

Cr

1.62.177

Monomando empotrar baño-ducha

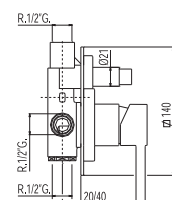

91.34.288

Cr

1.62.180

Distribuidor empotrado de 5 vías
con cierre y regulación de
caudal (1 entrada y 5 salidas)

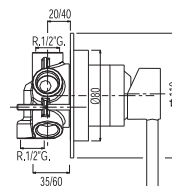

Cr

1.34.550

MAX-TRES

Conjuntos empotrados Ref.:



N

Kit de ducha monomando empotrado MAX
 con cierre y regulación de caudal. Ducha fija Ø 300 mm. (1.34.137.30).
 Material Latón. Soporte con toma pared (299.639.05). Ducha móvil anticalcárea (034.116.01) y flexo SATIN (91.34.609.15).

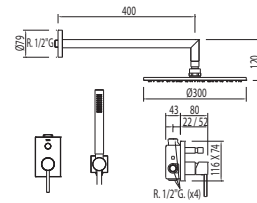

LATÓN



LATÓN



91.30.190

Cr

062.980.01



N

Kit de ducha monomando empotrado MAX
 con cierre y regulación de caudal. Ducha INOX 160x550 mm. (299.903.03).
 Soporte con toma pared. (299.639.05). Ducha móvil anticalcárea (034.116.01). Flexo SATIN (91.34.609.15).

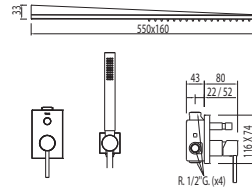

LATÓN



91.30.190

Cr

062.516.01



N

Kit de ducha monomando empotrado MAX
 con cierre y regulación de caudal. Ducha INOX con cascada 140x203 mm. (299.903.04). Soporte con toma pared (299.639.05). Ducha móvil anticalcárea (034.116.01). Flexo SATIN (91.34.609.15).

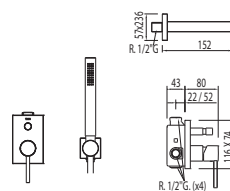

LATÓN



91.30.190

Cr

062.180.05

Cr = Cromo



Recomendado montar válvula SIMPLE RAPID (NO INCLUIDA)

Bañeras de repisa

Ref.:

N

Monomando bañera de repisa
con ducha anticálcarea (034.116.01)



°C
3 bar
16 l/m

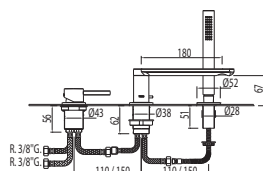

91.34.591

Cr

(180 mm)

062.161.03



LATÓN



LATÓN



91.34.591

Cr

(230 mm)

062.161.02

N

Kit depósito para bañeras de repisa
Fácil montaje superior. Sin registros

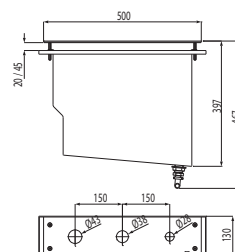

Sistema Patentado®

Cr

203.245.01

Monomando bañera de repisa
con ducha anticálcarea (034.116.01)



°C
3 bar
14 l/m

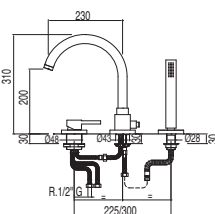

N

Cr

061.150.01

Nog

1.61.150.60



LATÓN



LATÓN

Cr

1.62.150

Monomando bañera de repisa
con caño cascada y ducha móvil anticálcarea
(034.116.01).



°C
3 bar
17 l/m

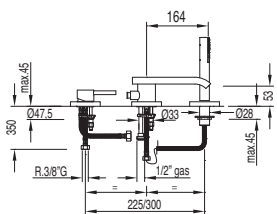

N

Cr

061.161.01

Nog

1.61.161.60



LATÓN



LATÓN

Cr

1.62.161

Kit depósito para bañeras de repisa
Fácil montaje superior. Sin registros

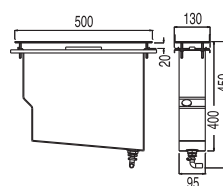



Sistema Patentado®

Cr



1.62.245

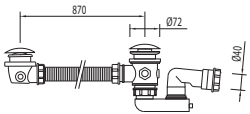

Cr = Cromo Nog = Grifo cromado con volante de Nogal

MAX-TRES

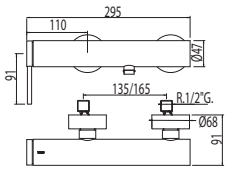
	<p>Válvula bañera con toma drenaje</p>		<p>Ref.: </p> 
			<p>Cr 1.34.445</p>

Monomando baño MONO-TERM®

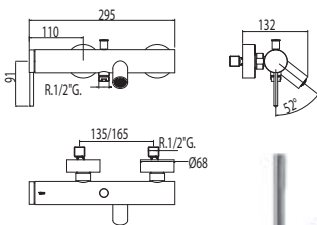
<p>N</p>	<p>Monomando ducha Ducha móvil anticalcárea (034.116.01) y flexo SATIN (91.34.609.15).</p>		 LATÓN	<p>Cr 062.168.01</p>
-----------------	--	--	--	----------------------

<p>N</p>	<p>Monomando bañera- ducha Ducha móvil anticalcárea (034.116.01) y flexo SATIN (91.34.609).</p>		 LATÓN	<p>Cr 062.178.01</p>
-----------------	---	--	--	----------------------

Cr = Cromo

Empotrados MONO-TERM®

Ref.:



MONO-TERM® de empotrar ducha
con cierre y regulación de caudal

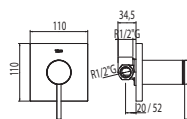

Cr

201.177.01



MONO-TERM® de empotrar baño-ducha
con cierre y regulación de caudal

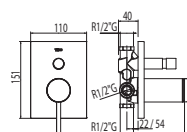

Cr

201.180.01

Conjuntos MONO-TERM®

Ref.:

N



Kit MONO-TERM® de empotrar ducha
con cierre y regulación de caudal. Ducha fija Ø 300 mm. (1.34.137.30).
Material Latón. Soporte con toma pared (299.639.05). Ducha móvil
anticalcárea (034.116.01) y flexo SATIN (91.34.609.15).

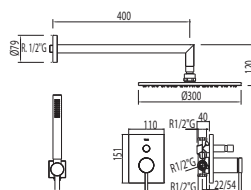

LATÓN



LATÓN

Cr

062.180.03

MAX-TRES

Ref.:



N

Kit MONO-TERM® de empotrar ducha

con cierre y regulación de caudal. Ducha INOX con cascada 140x203 mm. (299.903.04). Soporte con toma pared (299.639.05). Ducha móvil anticalcárea (034.116.01). Flexo SATIN (034.116.01).

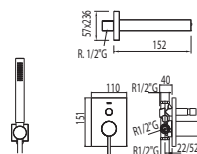

LATÓN

Cr 062.180.06



N

Kit MONO-TERM® de empotrar ducha

con cierre y regulación de caudal. Ducha fija Ø 300 mm. Material Latón. (1.34.137.30). Codo toma pared (299.639.06). Barra deslizante long. 850 mm. (1.34.619). Ducha móvil anticalcárea (034.116.01). Flexo SATIN (91.34.609.15).

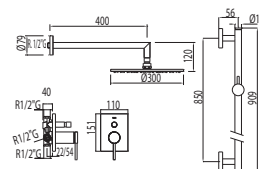

LATÓN



LATÓN

Cr 062.180.07



N

Kit MONO-TERM® de empotrar ducha

con cierre y regulación de caudal. Ducha fija Ø 300 mm. Material Latón. (1.34.137.30). Ducha móvil anticalcárea (034.116.01). Flexo SATIN (91.34.609.15). Con toma pared

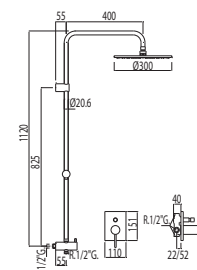

LATÓN



LATÓN

Cr 062.180.08

Cr = Cromo

Ref.:



Kit MONO-TERM® de empotrar ducha
con cierre y regulación de caudal. Ducha INOX con cascada 280x550 mm.
2 funciones (299.903.01)

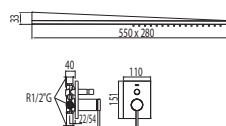

Cr 062.180.04



Kit MONO-TERM® de empotrar ducha
con cierre y regulación de caudal. Ducha INOX con cascada 500x500 mm.
2 funciones (299.516.02).

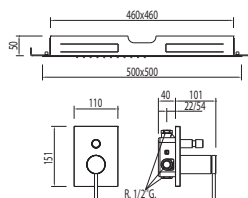

Cr 201.865.01



Barra de ducha MONO-TERM®
Ducha fija Ø 300 mm. Material Latón (1.34.137.30). Ducha móvil anticalcárea
(034.116.01) y flexo SATIN (91.34.609.15). Barra telescópica.

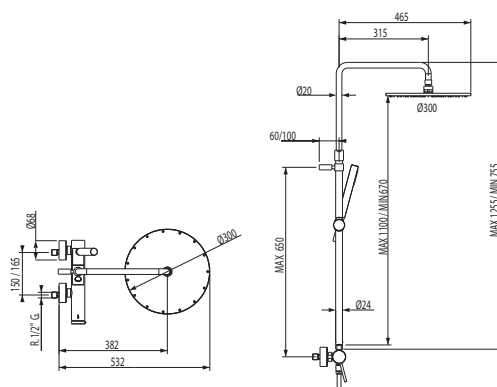

TRES TOUCH-COOL

Cr 062.378.01

Cr = Cromo

MAX-TRES

Termostáticas

Ref.:

N

Ducha MAX termostática
(Ducha móvil anticalcárea (034.116.01) y flexo SATIN (91.34.609.15)).

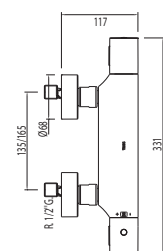

Cr 061.162.01



LATÓN

Cr 061.162.09

N

Bañera-ducha MAX termostática
Con cascada. (Ducha móvil anticalcárea (034.116.01) y flexo SATIN (91.34.609)).

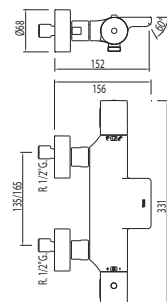

Cr 061.172.01



LATÓN

Cr 061.172.09

Ducha termostática
Ducha anticalcárea (299.631.03) y flexo SATIN (91.34.609.15). **Indicado para personas con discapacidades físicas**

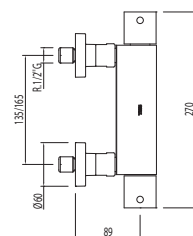

Cr 090.964.01

Bañera-ducha termostática
Ducha anticalcárea (299.631.03) y flexo SATIN (91.34.609). **Indicado para personas con discapacidades físicas**

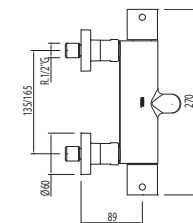

Cr 090.974.01

N

Codo adaptador baño-ducha



Con silenciador

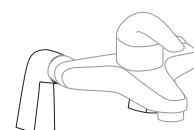
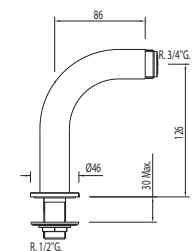

Cr 299.870.01

Cr = Cromo

Conjuntos termostáticos

Ref.:

N

Conjunto ducha MAX termostática

Ducha fija Ø 300 mm. Material Latón (1.34.137.30). Ducha móvil anticalcárea (034.116.01) y flexo SATIN (91.34.609.15). Inversor integrado en el regulador de caudal (ver pág. 576)



TRES TOUCH-COOL®

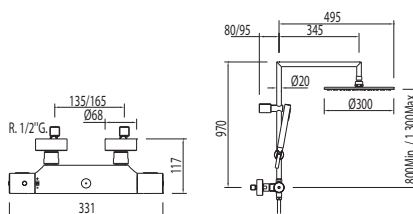

LATÓN



LATÓN

Cr

061.393.01

N

Conjunto ducha MAX termostática

Ducha fija Ø 300 mm. Material Latón (1.34.137.30). Ducha móvil anticalcárea (034.116.01) y flexo SATIN (91.34.609.15). Barra telescópica. Inversor integrado en el regulador de caudal (ver pág. 576)



TRES TOUCH-COOL®

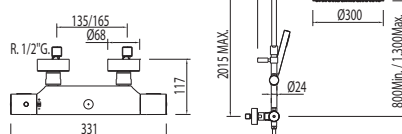

LATÓN



LATÓN

Cr

061.210.01

Conjunto bañera-ducha MAX termostática

Ducha fija Ø 300 mm. Material Latón (1.34.137.30). Ducha móvil anticalcárea (034.116.01) y flexo SATIN (91.34.609.15). Barra telescópica. Inversor integrado en el regulador de caudal (ver pág. 576)



TRES TOUCH-COOL®

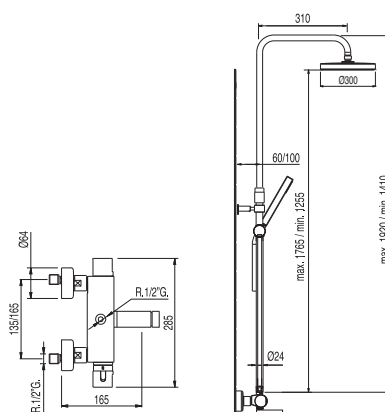

LATÓN



LATÓN

Cr

1.90.312

Cr = Cromo

MAX-TRES

Ref.:



N

Kit de ducha termostático empotrado MAX
 con cierre y regulación de caudal. (2 vías) Ducha fija Ø 300 mm. Material Latón (1.34.137.30). Soporte con toma pared (299.639.05). Ducha móvil anticalcárea (034.116.01). Flexo SATIN (91.34.609.15).

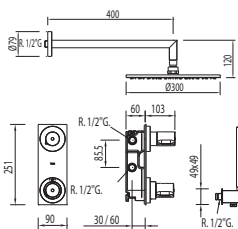

LATÓN



LATÓN



Cr 061.175.02



N

Kit de ducha termostático empotrado MAX
 con cierre y regulación de caudal. (2 vías) Ducha INOX 210x550 mm. (299.903.02). Soporte con toma pared (299.639.05). Ducha móvil anticalcárea (034.116.01). Flexo SATIN (91.34.609.15).

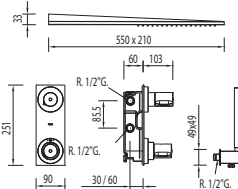

LATÓN



Cr 061.865.01



N

Kit de ducha termostático empotrado MAX
 con cierre y regulación de caudal. (2 vías) Ducha INOX con cascada 140x203 mm. (299.903.04). Soporte con toma pared (299.639.05). Ducha móvil anticalcárea (034.116.01). Flexo SATIN (91.34.609.15).

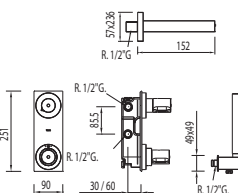

LATÓN



Cr 061.250.05

Cr = Cromo

Ref.:

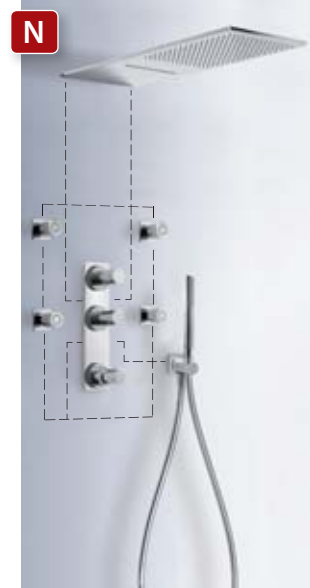
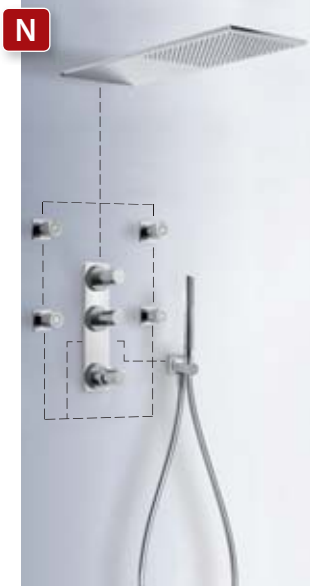

Kit de ducha termostático empotrado MAX

con cierre y regulación de caudal. (3 vías) Ducha INOX con cascada 280x550 mm. 2 funciones (299.903.01). Soporte con toma pared. (299.639.05). Ducha móvil anticalcárea. (034.116.01). Flexo SATIN (91.34.609.15).

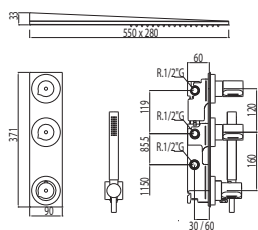

Cr 061.250.06

Kit de ducha termostático empotrado MAX

con cierre y regulación de caudal. (3 vías) Ducha INOX 210x550 mm. (299.903.02). 4 jets antical orientables (299.515.03). Soporte con toma pared. (299.639.05). Ducha móvil anticalcárea (034.116.01). Flexo SATIN (91.34.609.15).

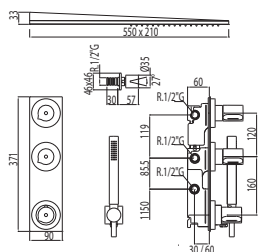

Cr 061.869.01

Kit de ducha termostático empotrado MAX

con cierre y regulación de caudal. (4 vías) Ducha INOX con cascada 280x550 mm. 2 funciones (299.903.01). 4 jets antical orientables (299.515.03). Soporte con toma pared. (299.639.05). Ducha móvil anticalcárea. (034.116.01). Flexo SATIN (91.34.609.15).

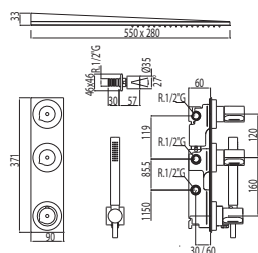

Cr 061.866.01

Cr = Cromo

MAX-TRES

Ref.:

N

Termostática bañera MAX

con caño cascada. Soporte con toma pared (299.639.05). Ducha móvil anticalcárea. (034.116.01). Flexo SATIN (91.34.609).



TRES BLOCK-SYSTEM

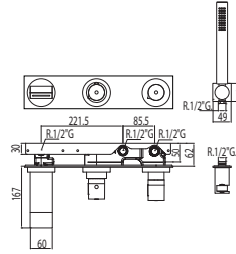

LATÓN

Cr

061.192.02

Caño cascada

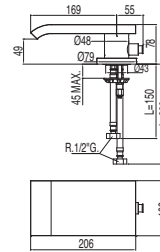

Cr

1.62.161.50

Llaves de paso

Ref.:

N

Llave de paso 1/2"

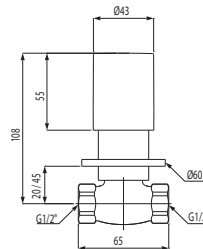

Cr

061.155.01

N

Llave de paso 3/4"

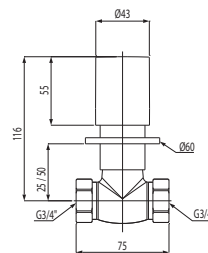

Cr

061.511.01

Cr = Cromo

Recambios

	Maneta	<table border="1"> <tr><td>Cr</td><td>91.34.078</td><td></td></tr> <tr><td>Ac</td><td>91.34.078.53</td><td></td></tr> </table>	Cr	91.34.078		Ac	91.34.078.53			Conjunto distribuidor (para ref.: 62.180)	<table border="1"> <tr><td>Cr</td><td>91.62.180.30</td><td></td></tr> </table>	Cr	91.62.180.30	
Cr	91.34.078													
Ac	91.34.078.53													
Cr	91.62.180.30													
	Volante	(para ref.: 61.103, 66.103, 61.107, 66.107, 61.120, 66.120, 61.150, 61.203, 66.203, 61.207, 66.207, 61.868, 61.874) <table border="1"> <tr><td>Cr</td><td>91.34.075</td><td></td></tr> <tr><td>Nog</td><td>91.34.107</td><td></td></tr> </table>	Cr	91.34.075		Nog	91.34.107			Soporte ducha pasamuro (para ref.: 61.150, 62.150)	<table border="1"> <tr><td>Cr</td><td>91.62.145.40</td><td></td></tr> </table>	Cr	91.62.145.40	
Cr	91.34.075													
Nog	91.34.107													
Cr	91.62.145.40													
	Volante lado caudal	(para ref.: 90.161, 90.171, 61.155, 61.511, 61.153, 61.154, 61.156, 61.175, 61.176, 61.178, 61.179, 61.182, 61.183, 61.184, 61.185) <table border="1"> <tr><td>Cr</td><td>91.94.058.02</td><td></td></tr> <tr><td>Nog</td><td>91.94.107.01</td><td></td></tr> </table>	Cr	91.94.058.02		Nog	91.94.107.01			Aireador (para ref.: 62.503, 62.603) M.18x1	<table border="1"> <tr><td>Cr</td><td>92.62.503</td><td></td></tr> </table>	Cr	92.62.503	
Cr	91.94.058.02													
Nog	91.94.107.01													
Cr	92.62.503													
	Volante lado temperatura	(para ref.: 61.195, 61.198, 61.395, 61.398, 90.212, 90.312, 90.281, 90.481) <table border="1"> <tr><td>Cr</td><td>91.94.058.28</td><td></td></tr> </table>	Cr	91.94.058.28			Desagüe automático 1,1/4"	<table border="1"> <tr><td>Cr</td><td>91.34.275.10</td><td></td></tr> </table>	Cr	91.34.275.10				
Cr	91.94.058.28													
Cr	91.34.275.10													
	Cartucho termostático + volante	(Para grupo de ducha y baño-ducha) <table border="1"> <tr><td>Cr</td><td>91.94.161.01</td><td></td></tr> </table>	Cr	91.94.161.01			Conjunto varilla y pulsador	<table border="1"> <tr><td>Cr</td><td>91.34.275</td><td></td></tr> </table>	Cr	91.34.275				
Cr	91.94.161.01													
Cr	91.34.275													
	Capuchón	<table border="1"> <tr><td>Cr</td><td>91.61.103.03</td><td></td></tr> </table>	Cr	91.61.103.03			Montura cerámica (para ref.: 62.503)	<table border="1"> <tr><td></td><td>91.34.272.20</td><td></td></tr> </table>		91.34.272.20				
Cr	91.61.103.03													
	91.34.272.20													
	Florón con excéntrica y silenciador	<table border="1"> <tr><td>Cr</td><td>91.61.170.19</td><td></td></tr> </table>	Cr	91.61.170.19			Conjunto bloqueo lavabo y bidé	<table border="1"> <tr><td></td><td>96.61.103.01</td><td></td></tr> </table>		96.61.103.01				
Cr	91.61.170.19													
	96.61.103.01													
	Conjunto distribuidor	(para ref.: 62.150, 62.161, 61.150, 61.161, 61.181) <table border="1"> <tr><td>Cr</td><td>91.63.147.10</td><td></td></tr> </table>	Cr	91.63.147.10			Conjunto bloqueo alargadera	<table border="1"> <tr><td></td><td>91.61.840.10</td><td></td></tr> </table>		91.61.840.10				
Cr	91.63.147.10													
	91.61.840.10													